

MATERIAL AND FINISHES

CABLE DIA 0.8MM CABLE

SMB CONNECTOR

HEAT SHRINK TUBE VERSAFIT V2

BODY BRASS
PLATED GOLD

CENTER CONTACT BRASS
PLATED GOLD

INSULATOR TEFLON

WASHER PHOSPHOR BRONZE

PLATED GOLD

NUT BRASS

PLATED GOLD

MMCX CONNECTOR

BODY, CAP BRASS
PLATED GOLD

CONTACT BRASS
PLATED GOLD

INSULATOR TEFLON

SNAP RING BERYLLIUM COPPER
PLATED GOLD

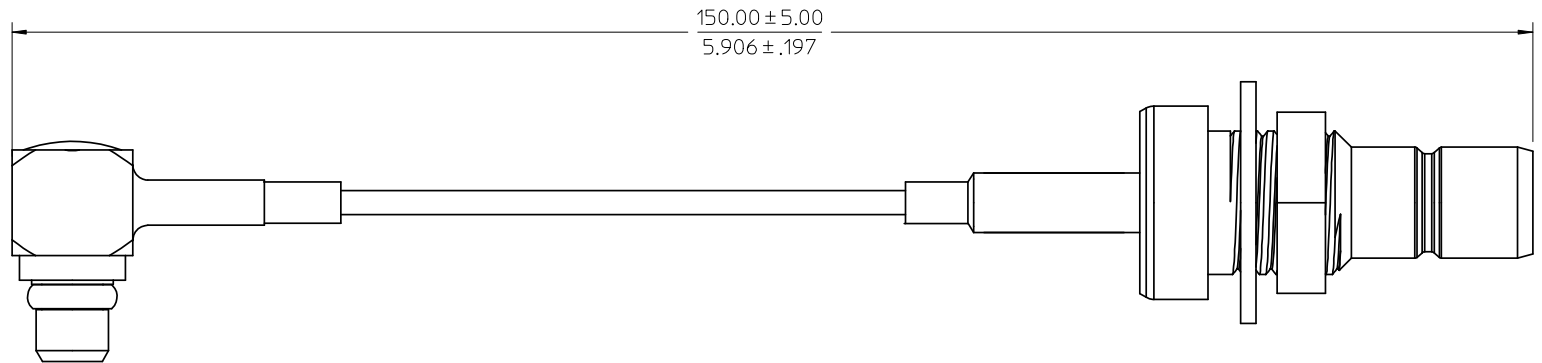
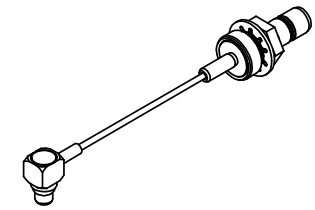

AS-89678-9490

MMCX INTERFACE

MIL-STD-348A, FIG. 311.2

SMB INTERFACE

SPECIFICATION

DESCRIPTION

NEW PDR06-133

EC NO: 2006/03/28
DRWN:CLLI
CHKD:
APPR:

QUALITY SYMBOLS
▽=0
▽=0

GENERAL TOLERANCES (UNLESS SPECIFIED)

	mm	INCH
4 PLACES	± .005	± .0004
3 PLACES	± .008	± .0003
2 PLACES	± 0.13	± .005
1 PLACE	± 0.25	± .010

ANGULAR ± 2 °
DRAFT WHERE APPLICABLE
MUST REMAIN
WITHIN DIMENSIONS

DIMENSION STYLE		SCALE	DESIGN UNITS	THIRD ANGLE PROJECTION
MM/IN			METRIC	
DRAWN BY	DATE	TITLE		
CLLI	2006/03/28	CAL ASSY, SMB BLK/JACK TO MMCX R/A 0.8 CABLE CAL-SMB/MMCX		
CHECKED BY	DATE	MOLEX INCORPORATED		
KERRIE	2006/03/28	SD-PDR06-134		
APPROVED BY	DATE	SHEET NO.		
MISEN	2006/03/28	1 OF 1		

MATERIAL NO. ---
SIZE A2

THIS DRAWING CONTAINS INFORMATION THAT IS PROPRIETARY TO MOLEX INCORPORATED AND SHOULD NOT BE USED WITHOUT WRITTEN PERMISSION